

BURY OLD ROAD/HEYWOOD ROAD, PRESTWICH
 PROPOSED INTRODUCTION OF PUSH BUTTON PEDESTRIAN FACILITIES

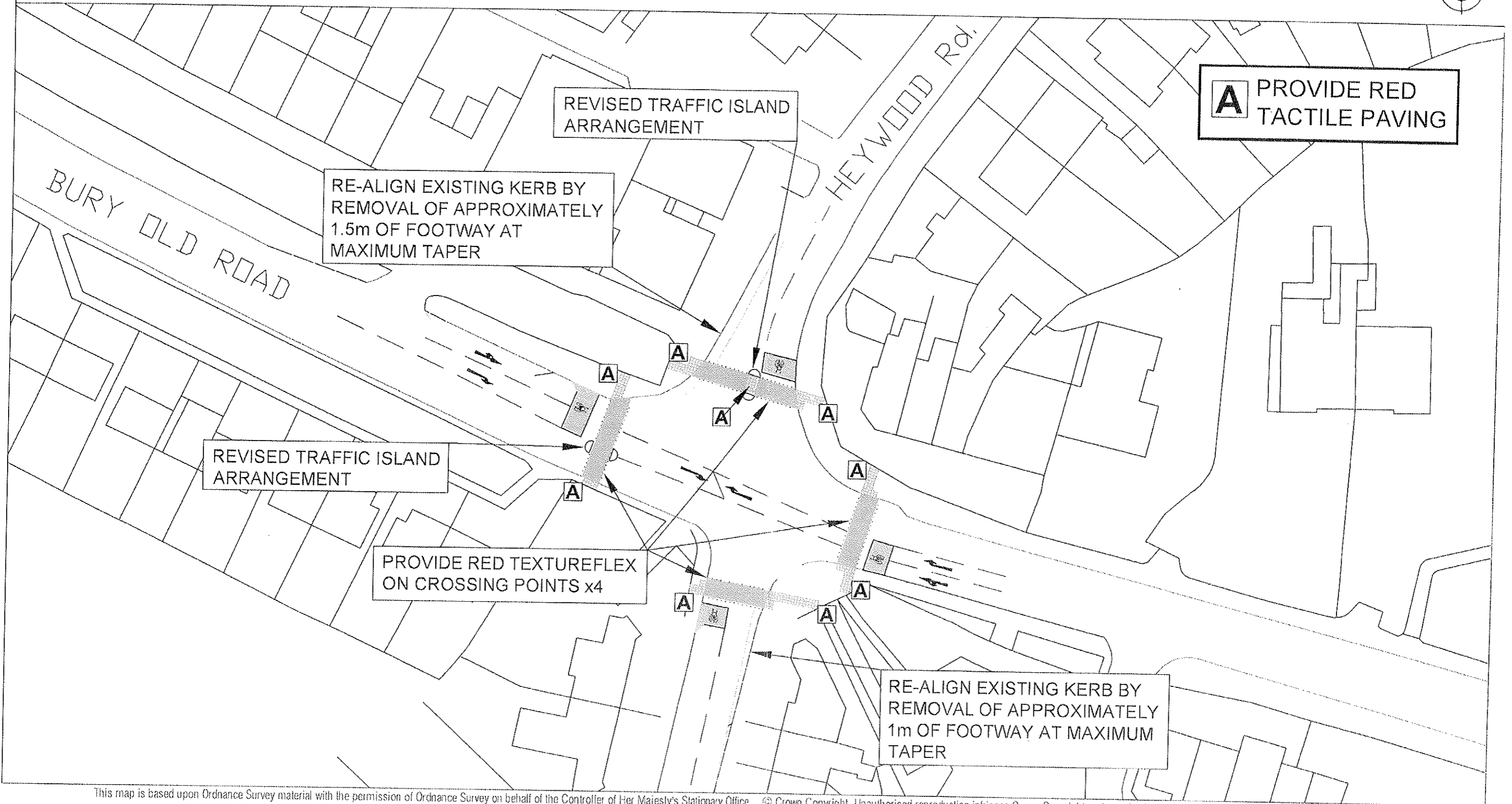
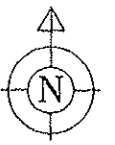

A PROVIDE RED TACTILE PAVING

REVISED TRAFFIC ISLAND ARRANGEMENT

RE-ALIGN EXISTING KERB BY REMOVAL OF APPROXIMATELY 1.5m OF FOOTWAY AT MAXIMUM TAPER

REVISED TRAFFIC ISLAND ARRANGEMENT

PROVIDE RED TEXTUREFLEX ON CROSSING POINTS x4

RE-ALIGN EXISTING KERB BY REMOVAL OF APPROXIMATELY 1m OF FOOTWAY AT MAXIMUM TAPER

This map is based upon Ordnance Survey material with the permission of Ordnance Survey on behalf of the Controller of Her Majesty's Stationary Office © Crown Copyright. Unauthorised reproduction infringes Crown Copyright and may lead to prosecution or civil proceedings. 100023063/2007

PLAN TM4823
 DATE 20.11.07
 DRAWN MRT
 SCALE 1:500

Environment and Development Services
 Planning, Engineering and Transportation Services Division
 Traffic Management Services

Lester House
 21 Broad Street, Bury, BL9 0AW

Telephone 0161-253 5828
 Fax 0161- 253 5363

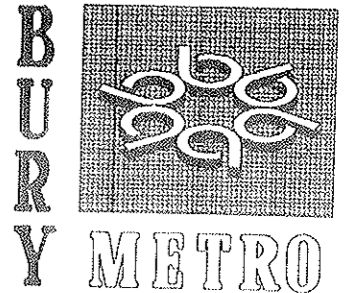

PHOTOGRAPHIC COPY LIABLE TO DISTORTION IN SCALE